



# USER INSTRUCTION MANUAL & WARRANTY



# USER INSTRUCTION MANUAL & WARRANTY

---

Thank you for choosing *MAGICWHEELS™* 2-Gear Wheelchair Drive, an all mechanical product with no batteries to charge or motors to wear down. *MAGICWHEELS™* 2-gear wheels are a sealed unit with no maintenance required. If any servicing is needed, it must be provided by the Magic Wheels, Inc. factory.

Please contact MAGIC WHEELS, INC. directly with any questions regarding your new 2-gear wheels at 1-866-MagicWh (866-624-4294) or [info@magicwheels.com](mailto:info@magicwheels.com).

*MAGICWHEELS is a trademark of Magic Wheels, Inc. Seattle, Washington.*



## Table of Contents

SAFETY WARNINGS .....	4
Wheelchair Safety .....	4
<b>MAGICWHEELS™</b> 2-Gear Wheelchair Drive Limitations.....	5
Anti-Tippers Recommendation.....	5
Installing <b>MAGICWHEELS™</b> 2-Gear Wheels.....	6
Quick Release Axles .....	6
<b>MAGICWHEELS™</b> 2-Gear Wheelchair Drive Axles.....	7
Adaptors .....	7
Does your wheelchair have an Axle Plate or need an Adaptor? .....	8
Installing <b>MAGICWHEELS™</b> on your wheelchair. ....	10
Removing <b>MAGICWHEELS™</b> from your wheelchair.....	11
Shifting and Using <b>MAGICWHEELS™</b> 2-Gear Wheels .....	12
Shifting into High (Standard) and Low (Climbing & Control) Gears .....	12
High (Standard) Gear .....	13
Low (Climbing & Control) Gear .....	13
Wheelies WARNING.....	13
<b>MAGICWHEELS™</b> 2-Gear Wheelchair Drive Hill Holding.....	14
Hill Holding.....	14
Hill Holding Override.....	14
Finger Actuated Stopping Assist.....	15
Handrims .....	16
Handrim Options.....	17
Handrim Assembly and Removal .....	18
Change Hand Rims.....	18
Maintenance .....	20
Tire Replacement .....	20
Tire Pressure .....	20
Cleaning <b>MAGICWHEELS™</b> .....	20
Limited Warranty.....	21

# SAFETY WARNINGS

---

PLEASE READ BEFORE USING *MAGICWHEELS™* 2-GEAR WHEELS

PRIOR TO THE FIRST USE OF *MAGICWHEELS™* 2-GEAR WHEELCHAIR DRIVE READ THE FOLLOWING INSTRUCTIONS. IF ANYTHING IN THE INSTRUCTIONS IS UNCLEAR, PLEASE CONTACT MAGIC WHEELS, INC. at 1-866-MagicWh (866-624-4294) OR YOUR LOCAL PROVIDER. IMPROPER OR INAPPROPRIATE USE COULD CAUSE SERIOUS INJURY OR DEATH TO THE WHEELCHAIR USER OR DAMAGE TO THE WHEELCHAIR.

**NOTE:** *MAGICWHEELS™* 2 GEAR WHEELCHAIR DRIVE, WITH TIRES THE SAME OUTSIDE DIAMETER SIZE AS YOUR EXISTING TIRES, WILL NOT CHANGE YOUR SEATED POSITION, POSTURE WHEN SEATED, BALANCE WHEN SEATED, OR ANY OTHER ASPECT OF YOUR POSITION IN YOU CURRENT WHEELCHAIR. IF YOU ARE NOT HAPPY OR COMFORTABLE WITH THE FEATURES OF YOUR CURRENT WHEELCHAIR DURING HILL CLIMBING OR YOUR POSITION IN IT, PLEASE CONTACT YOUR LOCAL WHEELCHAIR PROVIDER. YOUR 2-GEAR WHEELS ARE NOT DESIGNED TO CORRECT PROBLEMS WITH POSITIONING OR BALANCE.



## IMPORTANT

### Wheelchair Safety

Always use wheelchair within the limits of your physical ability and according to the user guidelines written in your Wheelchairs Owner's Manual.

## CAUTION

### **MAGICWHEELS™ 2-Gear Wheelchair Drive Limitations**

- Maximum rider weight is 250 pounds.
- Maximum axle camber is 10 degrees.
- Rider weight over 200 pounds, maximum axle camber is 6 degrees.
- Do not soak or submerge your 2-gear wheels in water (fresh or salt).
- Do not hose down your 2-gear wheels with water.
- Do not use your 2-gear wheels in fine sand.
- Do not use solvents, abrasive cleaners or bleaches to clean your 2-gear wheels.
- Do not break gear box seal to open the hub of your 2-gear wheels. (This voids the warranty).
- Do not use 2-gear wheels in the Lower (Climbing & Control) Gear if the outboard (handrim) side of the carbon fiber wheel has been damaged. Your fingers can get caught in the wheels if there is a hole or tear in the carbon fiber. If damage has occurred to outboard (handrim) side of the wheel, only use your 2-gear wheels in High (Standard) Gear until the carbon fiber has been fixed.

## WARNING

### **Anti-Tippers Recommendation**

Magic Wheels, Inc. recommends that you use anti-tippers on your wheelchair while learning to use your 2-Gear Wheelchair Drive and while learning to do wheelies in Low (Climbing & Control) gear. Tipping backwards can occur when the **MAGICWHEELS™ 2-Gear Wheelchair Drive Hill-Holding** feature is engaged while the wheels are in the Low (Climbing & Control) gear. This is especially hazardous for experienced wheelchair users who are not used to having a Hill-Holding feature in their wheels and are used to spinning quickly to turn around.

# INSTALLING *MAGICWHEELS™* 2-GEAR WHEELS

---

## WARNING

DO NOT INSTALL *MAGICWHEELS™* 2-GEAR WHEELS ON YOUR WHEELCHAIR IF: the structure is bent, has cracks, has ground off or missing parts, or has any significant damage. Your 2-gear wheels must be installed on the original manufacturer's axle plate or axle, which must be in good condition.

## WARNING

INSTALL *MAGICWHEELS™* 2-GEAR WHEELS ONLY ON THE WHEELCHAIR FOR WHICH IT WAS CONFIGURED. Written consent from Magic Wheels, Inc. is required for any other installation. Call 1-866-Magicwh (624-4294) for further information or assistance or e-mail [info@magicwheels.com](mailto:info@magicwheels.com).

## WARNING

Clean and lube the axle of your wheelchair before installing your 2-gear wheels. DO NOT USE PENETRATING LUBRICANTS (such as WD-40® or 3-in-1 oil®) on the quick release axles or chassis receivers (the opening where the axles are inserted into the wheelchair). Clean and lube both the long quick-release axles and the short secondary anti-rotation axles weekly. Teflon® based lubricants work best.)

## Quick Release Axles

### CAUTION

Use caution when placing your 2-gear wheels in your car, trunk, or in any location where they might be pushed into one another. *MAGICWHEELS™* 2-gear wheel axles do NOT slide in the wheels like standard wheel axles. These axles have sharp edges and can puncture the carbon fiber wheels or other objects if they are pushed against them. Do not slam doors and trunk lids onto wheels. The best way to store your 2-gear wheels for transport is to place them handrim to handrim so the axles are pointing away from each other.

## **MAGICWHEELS™ 2-Gear Wheelchair Drive Axles**

If you look at the back of your 2-gear wheels (Figure 1), you will notice the standard axle as well as a second pin. This pin makes the gears work inside your wheels and must be fixed to your chair in such a way that it will not rotate.



Figure 1 (Axle & Pin)

### **Adaptors**

**MAGICWHEELS™** 2-gear wheels are designed to fit on almost every style of manual wheelchair and they are interchangeable with most standard spoke wheels.

Your 2-gear wheels will utilize your wheelchair's existing axle mounting system. However, **MAGICWHEELS™** 2-gear wheelchair drive's unique geared transmission may require a small adaptor (See Figure 2) installed onto the frame of your wheelchair to keep the anti-rotation pin from turning and allow proper shifting.

## **WARNING**

Adaptors (if required) for your 2-gear wheels must be installed onto the frame of your wheelchair for the wheels to work properly in Low (Climbing & Control) gear. Improper installation can result in injury to the user and/or others. Follow the proper step by step installations instructions provided by Magic Wheels, Inc. Each adaptor is configured for the specific make and model of wheelchair onto which the *MAGICWHEELS™* 2-gear wheelchair drive is being installed. If you do not have the proper installation instructions, please contact Magic Wheels, Inc. at 1-866-MagicWh (866-624-4294) to obtain them.

### **Does your wheelchair have an Axle Plate or need an Adaptor?**

If your wheelchair has an axle plate (Figure 3) then you do not need an adaptor. The pin is made to fit into the elongated slot in your axle plate next to where the axle goes into your wheelchair.

If your wheelchair does not have an axle plate, please contact Magic Wheels, Inc. at 1-866-MagicWh (866-624-4294) to find out what adapter you will need. Magic Wheels, Inc has adaptors available to fit most manual chairs.

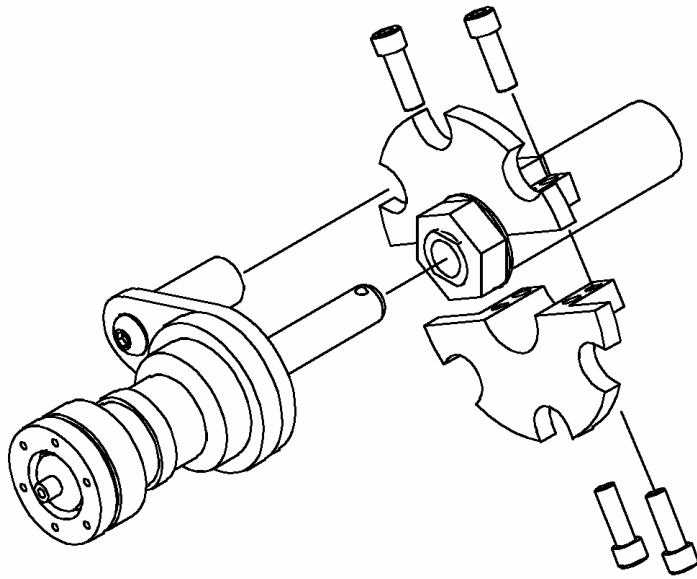

Figure 2 (Standard Adaptor)

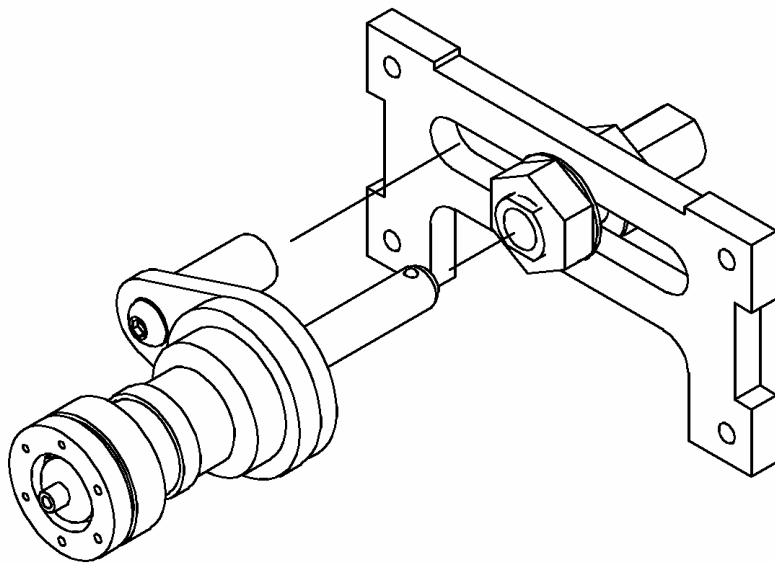

Figure 3 (Axle Plate)

## Installing *MAGICWHEELS™* 2-gear wheels on your wheelchair

### CAUTION

*MAGICWHEELS™* are a directional set of wheels and must be installed on the proper side of your wheelchair (Right & Left). On the inside sticker of each wheel, you will find an “L” for the Left wheel and an “R” for the right wheel.

### CAUTION

Installing your *MAGICWHEELS™* 2-gear wheels on the wrong side of your wheelchair does no damage to the wheels. If your Magic Wheels have been installed on the improper side, your High (Standard) gear will still work normally. You will also still be able to shift the wheels. The only difference is the Low (Climbing & Control) gear will now shift and roll backwards. If you notice that your 2-gear wheels have been installed on the improper side, use only in High (Standard) gear until they have been re-installed on the correct side.

◆ **NOTE:** *MAGICWHEELS™* 2-Gear wheels use the same quick release axles installed on standard wheelchairs.

To operate the quick release:

1. Put your fingers into the open Finger Pocket on the shift handle in the center of the rear wheel.
2. Push in the button with your thumb to release the quick-release axle then pull the axle and wheel away from the wheelchair.
3. Repeat Step 1 for the opposite wheel.

## INSTALLATION

1. Remove original rear wheels.
2. Put your fingers into the open Finger Pocket on the shift handle in the center of the 2-gear wheel you wish to install.
3. Push in the button with your thumb to release the quick-release axle then insert the center axle into the wheelchair’s axle receiver and push the wheel in just as you would a standard wheelchair wheel.

4. Rotate the wheel until the Pin (Figure 1) lines up with either the axle plate opening (Figure 3) or the notch in the adaptor (Figure 2). Push the wheel completely into the axle receiver until the button in the center of the wheel pops out.

◆ **INSTALLATION TIP:** For easier install, when placing *MAGICWHEELS™* 2 gear wheels on the wheelchair, first shift the wheels into Low (Climbing & Control) gear. This will allow the pin to be easily rotated around the inside of the wheel by turning the handrim and wheel together until the pin aligns with the slot in the axle plate or a slot in the adaptor.

### **WARNING**

If the button does not pop out then your axle is not locked into the frame of your wheelchair and the wheel can slide out. **IF THE BUTTON DOES NOT POP OUT WHEN INSTALLING THE 2-GEAR WHEELS ONTO YOUR WHEELCHAIR, DO NOT USE YOUR WHEELS.**

## Removing *MAGICWHEELS™* 2-Gear wheels from your wheelchair

1. Remove the 2-gear wheels the same way you remove standard quick release wheels.
2. Put your fingers into the open Finger Pocket on the shift handle in the center of the rear wheel.
3. Push in the button with your thumb to release the quick-release axle then pull the axle and wheel away from the wheelchair.

# Shifting and Using *MAGICWHEELS™* 2 GEAR WHEELS

---

## Shifting into High (Standard) Gear and Low (Climbing & Control) Gear

*MAGICWHEELS™* 2-gear wheel have a 3 arm shift handle on each wheel. (See Figure 4)



Figure 4 (Shift Handle)

Shifting must be done while wheel is stopped or moving very slowly with no turning load on the wheel.

### **To Shift:**

Put your palm or wrist onto any of the 3 arms of the shift handle and push the top of Shift Arms forward or backward until you feel the gear engage.

- Push Shift Handle forward to shift into the Low (Climbing & Control) gear (2:1)
- Push Shift Handle backward to shift into High (Standard) gear (1:1)

◆ **NOTE:** Both wheels must be engaged separately. Be advised that you may wish to have only one wheel shifted into Low and one in High for certain uneven terrain.

### **High (Standard) Gear**

**MAGICWHEELS™** 2-gear wheel High (Standard) gear is the same 1:1 gear as your standard wheelchair wheels. The top of the shift handle must be pushed “backward” all the way to make sure your wheels are fully engaged in High (Standard) gear. **NOTE:** The shift handle disk is centered in High (1:1) gear.

### **Low (Climbing & Control) Gear**

**MAGICWHEELS™** 2-gear wheel Low (Climbing & Control) gear is a 2:1 gear which allows you to utilize all of the features of your 2-Gear Wheelchair Drive. The top of the shift handles must be pushed “forward” all the way to make sure your wheels are fully engaged in Low (Climbing & Control) gear. **NOTE:** The shift handle disk is off center in Low (2:1) gear.

## **WARNING**

### **READ BEFORE DOING WHEELIES IN LOW (2:1) GEAR**

Doing wheelies in Low (Climbing & Control) gear is a technique which is very different from doing wheelies in High (Standard) gear. While in Low (Climbing & Control) gear, the Hill Holding feature is always engaged so the wheelchair will NOT roll backwards unless the hand rims are being pulled back. Wheelies CAN be done in Low (Climbing & Control) gear but must be practiced extensively while USING ANTI-TIPPER WHEELS OR A SPOTTER IS BEHIND THE WHEELCHAIR IN CASE THE USER TIPS BACKWARDS. Continue to use anti-tippers until you can do a wheelie with full confidence that you won't tip over. **DOING WHEELIES IN LOW (2:1) GEAR CAN RESULT IN FALLING BACKWARDS AND CAN CAUSE SERIOUS INJURY OR DEATH.**

# *MAGICWHEELS™* 2-Gear Wheels Hill Holding

---

## Hill Holding

*MAGICWHEELS™* 2-gear wheelchair drive Low (Climbing & Control) gear includes a Hill Holding device that enables the wheelchair user to stop when climbing a hill and not roll backward. This feature can be overridden by moving the handrim backward to turn around if necessary; it immediately locks again when the handrim is released.

When the 2-gear wheels are shifted into Low (Climbing & Control) gear, the Hill Holding feature is automatically activated. The Hill Holding feature can also be used for transfer or for locking your chair in a position to prevent rolling backward.

To learn how to best utilize the Hill Holding feature, please practice these user guidelines on a hill:

- Shift the wheels into Low (Climbing & Control) gear
- Push handrims forward, stop your forward push, and let go of the handrims completely, then push forward again, stop your forward push and then let go of the handrims.

◆ **NOTE:** Since the Hill Holding feature stops the wheelchair from rolling backwards, there is no need to surge the wheelchair forward between each push.

## Hill Holding Override

To override the Low (Climbing & Control) gear's Hill Holding feature, pull back on either handrim when the Hill Holder feature is engaged. As long as the handrim is moving faster than the wheel, the wheel will roll backwards.

To turn around on a hill utilizing the override function, push one handrim "forward" until you have changed your direction by 45 degrees. Then pull back

on the opposing handrim until you have rotated another 45 degrees. Repeat both steps once more and then travel down the hill.

## **IMPORTANT**

Overriding *MAGICWHEELS™* 2-gear wheels Hill Holding feature to turn on steep hills can cause your wheelchair to lean sideways! Always make sure you are not beyond your tipping point on a hill. A fall, tip-over or loss of control may occur and cause serious injury to yourself or others.

## Finger Actuated Stopping Assist

---

*MAGICWHEELS™* 2-GEAR WHEELS SHOULD BE SHIFTED INTO LOW (Climbing & Control) GEAR WHILE GOING DOWN HILLS.

*MAGICWHEELS™* 2-gear wheels geared advantage enhances stopping capabilities by simply applying limited pressure to the handrims.

◆ **NOTE:** While in Low (Climbing & Control) gear and going down hill, the handrims will move twice as fast as the wheel.

◆ **NOTE:** *MAGICWHEELS™* 2-gear wheels may allow vinyl handrims to be used while going down hill since the 2-gear wheels provides more control to the user and less friction on the hands.

## **WARNING**

*MAGICWHEELS™* 2-gear wheelchair drive provides more control while maneuvering a wheelchair downhill or over rough terrain than standard wheels.

- Do not exceed the wheelchair manufactures recommended speed!
- Excess speed may cause the front casters to flutter. A fall, tip-over or loss of control may occur and cause serious injury to yourself or others.

# Handrims

---

## Handrim Options

Magic Wheels, Inc. has a variety of different handrim options. Please read the handrim diagrams to decide which handrim is best suited for your type of wheelchair usage.

◆ **NOTE:** While using your 2-gear wheels Low (climbing & control) gear, the handrim and the tire move at different speeds. This is similar to peddling a bike in low gear; the peddles turn much faster than the tires. Users who constantly push their tires instead of their handrims to propel their wheelchair may have a difficult time adjusting to this issue.

### **21"x3/4" Aluminum Handrims**

These are the same standard 21"x3/4" aluminum handrims used on wheelchairs for years. (No added width to wheelchair compared to standard handrims.)

### **21"x1" Aluminum Handrim**

These handrims are slightly larger than the standard 21"x3/4" handrims and are suggested for the wheelchair user who needs a larger tube diameter plus vinyl for grip reasons. (The larger diameter and the vinyl coating may add slight width to the wheelchair compared to standard handrims.)

### **21"x3/4" Vinyl Handrims**

These are the same standard 21"x3/4" handrims used on wheelchairs for years, just covered with vinyl. (No added width to wheelchair compared to standard handrims.)

### **21"x1" Vinyl Handrim**

These handrims slightly larger than standard 21"x3/4" handrims and are suggested for to the person who needs a larger tube diameter for grip reasons

but doesn't want the burn of vinyl. (The larger diameter may add slight width to the wheelchair compared to standard handrims.)

### **16"x1" Vinyl Handrim**

These handrims as a stand-alone product are recommended for the strong wheelchair user with full hand strength and full upper body function. They are a faster gear than standard handrims and require less effort when pushing at higher speeds. Please note that due to the smaller diameter handrim, when you initiate your first move, they are more difficult to push and make the wheelchair feel slightly heavier than standard handrims. (There is no added width to the wheelchair compared to standard handrims.)

### **Double Handrim**

The Double Handrims come with a 21"x3/4" aluminum outer handrim and a 16x1" vinyl center handrim. These new handrims offer several advantages over the standard 21" aluminum handrims usually found on wheelchairs. (See both 16" Vinyl and 21"x3/4" handrims below to view user info.)

By moving your hand from the outer handrim to the inner handrim when rolling, the user has a 2nd (faster) gear. There is also the advantage of the ability to use the vinyl on the inner handrim while pushing, then switching to the aluminum outer handrim to avoid the burn of vinyl while stopping.

The Double Handrim also provides your wheelchair with 2 high gears and 2 low gears, giving you a 4 speed wheelchair.

Vinyl can also be ordered on the outer handrim to avoid the grip problem of aluminum.

### **21"x3/4" Knob Handrims**

These handrims are for the wheelchair user with limitations in their hand, arm and/or upper body strength. Knobbed handrims come in several different variations and we have chosen the standard vinyl covered model with 8 - 1/2" knobs to offer with your 2-gear wheels.

## 16"x1" Knob Handrims

These handrims are for the wheelchair user with limitations in their hand, arm and/or upper body strength. The difference between these handrims and the 21"x3/4" are wheelchair users need to be able to reach beyond the standard 21" handrim. 16"x1" handrims are also slightly more difficult to push than standard 21"x3/4" handrims, so may require slightly more arm strength. These handrims have 6 - ½" push knobs.

## Natural-Fit™ Handrims

As a purchased upgrade, Magic Wheels, Inc. offers Natural-Fit™ SuperGrip handrims to be installed on *MAGICWHEELS™* 2-gear wheels. For more information on the Natural-Fit™ handrim you may contact: Three Rivers Holdings, LLC directly at 480-833-1829 ([www.3rivers.com](http://www.3rivers.com)). Or call Magic Wheels, Inc. at 866-624-4294. Natural-Fit is a trademark of Three Rivers Holding, LLC, Mesa, AZ.

## Handrim Assembly and Removal



### Hand Rim Sizes

*MAGICWHEELS™* 2-gear wheels may be special ordered with smaller than normal hand rims. Smaller hand rims may add speed to the wheelchair user's movements and can cause unexpected accidents.

- Do not exceed the wheelchair manufactures recommended speed!
- Excess speed may cause front casters to flutter and result in a fall, tip-over or loss of which can cause serious injury to yourself or others.

### Change Hand Rims

To change the handrim assembly, locate the (12) black self locking nuts in the spokes around the central drum (See Figure 5) and remove with a 1 1/32" socket wrench. Remove the complete handrim assembly by lifting it off of the drum using the spokes.

**Please Note:** Most handrims with a standard 6-hole 20.25" bolt pattern will fit on Magic Wheels.

**⚠ CAUTION**

**DO NOT REMOVE NUTS UNDER THE SPOKES OR BREAK THE SEAL ON THE GEAR BOX – THIS WILL INVALIDATE WARRANTY.**

Spokes are attached to handrim with six 10/32 x 1-1/4" screws, Loctite compound and six 1/4" hand rim spacers (if required). Assemble the desired hand rim and spacers onto the spokes, apply over the drum studs and replace the 12 self locking nuts.

**Additional Information:**

- -1/4" spacers are used on 16" rims with small spoke
- -1/8" spacers are used on 21"x3/4 aluminum handrims with large spoke
- -0" spacers used on 21"x1" handrims
- - if extra space is needed to increase width of the handrim, use 1/8" spacers

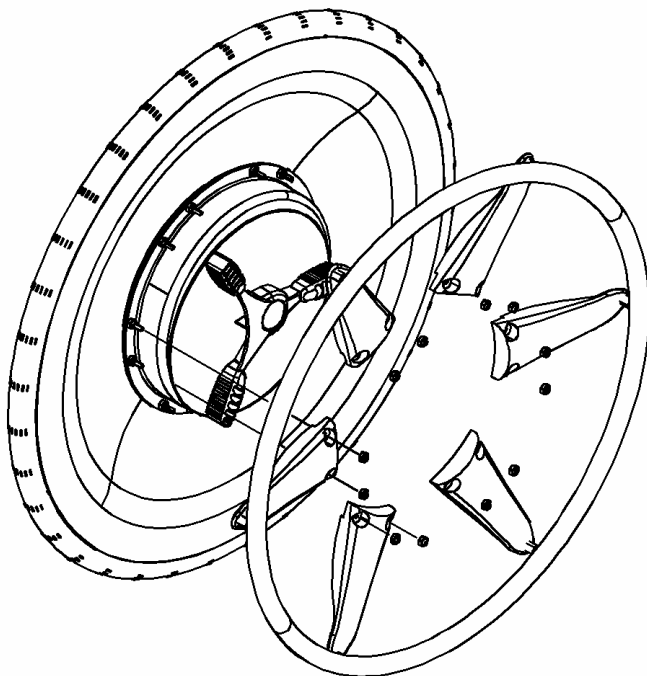

Figure 5 (Handrim Layout)

# Maintenance

---

## Tire Replacement

Replacement of the tire or tube **MUST** be performed by a qualified technician. A variety of 24" (540 mm) wheelchair tires are available from your local dealer to fit onto your 2-gear wheels. We recommend that only plastic tire tools be used when changing tires to prevent damage to the carbon fiber wheels.

## Tire Pressure

DO NOT use your wheelchair unless it has the proper tire pressure (psi). The recommended tire pressure is on the sidewall of each tire.

DO NOT over inflate the tires. Failure to follow these suggestions may cause the tire to explode and cause serious injury to yourself or others.

## Cleaning *MAGICWHEELS™* 2-gear wheels

Clean your 2-gear wheels with a slightly damp rag and a mild non-abrasive soap. Do not use solvents, abrasive cleaners or bleaches to clean your *MAGICWHEELS™* 2-gear wheels.

Your *MAGICWHEELS™* 2-gear wheelchair drive hub does not have a watertight seal; so do not hose down your wheels with water. If you need to rinse mud, dirt or other substances off your tires, put the hose only on the lower part of the tire & wheel so no water can enter the hub of the wheel.

- Do not soak or submerge your 2-gear wheels in water!
- Do not pressure wash your 2-gear wheels!

## Limited Warranty

---

Magic Wheels, Inc. warrants our *MAGICWHEELS™* 2-gear wheelchair drive for two (2) years from the date of the first consumer purchase. This warranty covers any defects in materials and workmanship on all working components of the wheels except those listed in the Two Year Warranty Exclusions below.

### TWO YEAR WARRANTY EXCLUSIONS

- Tires and tubes
- Damage to the carbon fiber “dish” wheels, except for factory defects
- Handrims, except for factory defects
- Damage from normal wear and tear
- Damage caused by failure to adhere to the Owners’ Manual
- Damage from improper installation or repair

In addition, Magic Wheels, Inc. offers an Extended Five (5) Year Warranty on the internal working components of the 2-speed hub assembly except those listed in the Five Year Warranty Exclusions below.

### FIVE YEAR WARRANTY EXCLUSIONS

- All exclusions listed in the Two Year Warranty Exclusions above
- External Components including the carbon fiber wheel assembly, spokes, handrims, shift handle, axle and adapter assembly
- Friction lining for Hill Holder Clutch. The factory will repair friction linings at cost on a pro-rated basis, see Our Responsibilities below.

### LIMITATIONS

- The warranty is VOID if the original serial number tag is removed or altered
- The warranty is VOID if the gear box seal is broken
- The warranty is VOID if the 2-speed wheels are used for any extreme sports
- The warranty is VOID if the 2-speed wheels are submersed
- The warranty is VOID if the 2-speed wheels are used with a load exceeding the weight limit of 250 pounds

- The warranty is VOID if the wheels are subjected to jumping or bouncing up or down steps greater than seven (7) inches in height
- The warranty is VOID if the wheels have been subjected to neglect, accident, improper maintenance, storage or operation as defined in the Owners' Manual
- The warranty is VOID if the 2-speed wheels are modified without Magic Wheels, Inc. express written consent
- This warranty applies only to the original purchaser from the date of purchase

## **YOUR RESPONSIBILITIES**

- If your wheels require warranty service, please contact the dealer from which you purchased the wheels.
- If you do not receive satisfactory dealer service, contact Magic Wheels, Inc. at the address below.
- Do not return the 2-speed wheels to Magic Wheels, Inc. without first obtaining a Return Authorization Number from Customer Service.
- Defective 2-speed wheels must be shipped to Magic Wheels, Inc. within 60 day of issuance of a Return Authorization Number by Customer Service.

## **OUR RESPONSIBILITIES**

- Magic Wheels, Inc.'s sole responsibility is to repair or replace, at our discretion, the covered components of the wheels. This is the exclusive remedy for consequential or incidental damages.
- Friction linings will be repaired at factory cost based on a prorated schedule. At two years or less, the linings will be repaired at no cost to the customer. From 2 to 5 years, the factory will prorate the customer cost based on the original purchase date.

Upon pre-approval, Magic Wheels, Inc. may provide exchange services for Warranty returns. Under this program, refurbished 2-gear wheels, without handrims, may be shipped to the dealer prior to return of the defective wheels for warranty repair (dealer will move customers existing handrims over to the new wheels). The customer's wheels would be exchanged at the dealer's facility. The exchange wheels may contain used parts that meet Magic Wheels' quality standards. This program is provided at the sole discretion of Magic Wheels, Inc. The original warranty term will not be extended due to such wheel

exchange and the returned wheels become the property of Magic Wheels, Inc. and the exchange wheels become the property of the purchaser.

#### **CONSUMER NOTICE**

- Unless prohibited by law, this warranty is in place of any other warranty (written or oral, express or implied), including any warranty of fitness for a particular purpose.
- This warranty gives you certain legal rights. You may have other rights that vary from state to state.

**For warranty information, please contact Magic Wheels, Inc. at:**

Magic Wheels, Inc.

3837 – 13th Avenue West, Suite #104

Seattle, Washington 98119

WEB: [info@magicwheels.com](mailto:info@magicwheels.com)

PHONE: 1-866-Magicwh (866-624-4294)

